



---

## Main datas

Builder : Vennekens  
Year : 1992  
Length : 19,15  
Draft minimum : 2,05  
Hull : Monohull

Subtype :  
Architect :  
Material : Steel  
Beam : 5,60  
keel : Fixed Keel

---

## Engines

Model : 3306BTA  
Montage : In Board (IB)  
Power Unit. (CV) : 350  
Hours : 2935  
Fuel capacity : 8500

Brand : CATERPILLAR  
Fuel : Diesel  
Engine(s) : 2  
Drive : Shaft drive

# Facilities

Sailor Cabin : 0  
WC : Electric  
Helm : Yes

Double Cabin : 4  
Head : 3  
Berth : 9  
Flybridge : Yes

---

## Technical Details

### Vennekens Trawler 20M

The Vennekens Trawler 20M is a traditional fishing boat, designed by the Belgian manufacturer Vennekens. This boat is renowned for its robustness, reliability, and elegant design, making it an ideal choice for sailing and fishing enthusiasts.

Main characteristics:

- Overall length: 20 meters -
- Width: 5 meters -
- Draft: 1.5 meters -
- Displacement: Approximately 40 tonnes -
- Construction material: Steel -
- Power: Powerful diesel engine, often a renowned brand like Scania or Volvo Penta, offering 300 to 500 horsepower. -
- Cruising speed: Approximately 10 to 12 knots -
- Fuel tank: Capacity of 2000 to 3000 liters, allowing for extended sea trips. -
- Fishing capacity: Equipped for commercial or recreational fishing, with facilities for fish storage and modern fishing equipment. -
- Onboard comfort: Spacious cabins, equipped kitchen, bathroom with shower, and a comfortable lounge for long voyages. -
- Navigation electronics: GPS, sonar, radar, and other modern navigation equipment for optimal safety and efficiency. -

The Vennekens Trawler 20M is a versatile boat, perfect for family outings, fishing trips, or even commercial use. Its robust construction and high-quality equipment make it a durable and reliable investment.

---

Limitation of liability : XBOAT assumes no responsibility for the information provided in this technical data sheet, which has been sourced from the internet and has not been verified. This information is non-contractual and does not, in any way, bind XBOAT.





































































































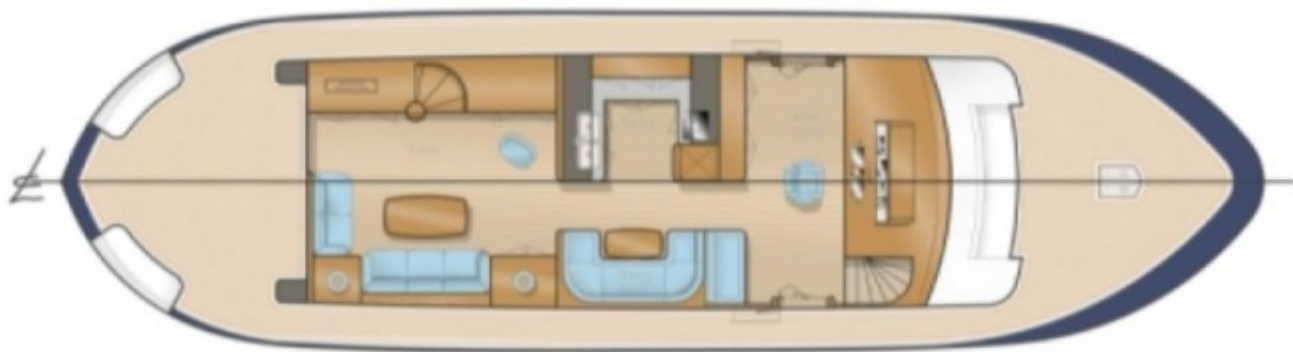

©Xboat

